

# M65 Compact Mixer-Amplifier

All-in-one solution for light commercial and industrial applications; restaurants, retail stores, coffee shops, medical/dental offices, schools, factories, warehouses and more.



Designed for the most common commercial installation requirements



Ideal for background music, mic, and paging with the ability to connect three external sources



Industry standard connectors to make installs fast and efficient



Front panel controls to easily manage source and master volumes with bass & treble control

## KEY SPECIFICATIONS

- 70V/25V/4Ω/8Ω, 65 Watts
- 2U Rack-mountable with optional RK-M3565
- 3 Mic/Line inputs
  - CH1 - Mic/Line on Phoenix terminal
  - CH2 - Mic on Phoenix terminal - Line on RCA
  - CH3 - Mic on Phoenix terminal - Line on RCA
  - CH3 - 3.5mm Aux on front panel
- Phantom Power support for primary mic
- (1) TELE-PAGING input, and (1) MOH/LINE OUT on 3-prongs Phoenix terminals
- Speaker outputs on 5-prongs Phoenix Terminals
- Power, Signal, -20dB, Clip and Protect Indicators
- Output Current Limiting, Thermal Protection & DC Offset protection

# Connection Diagram

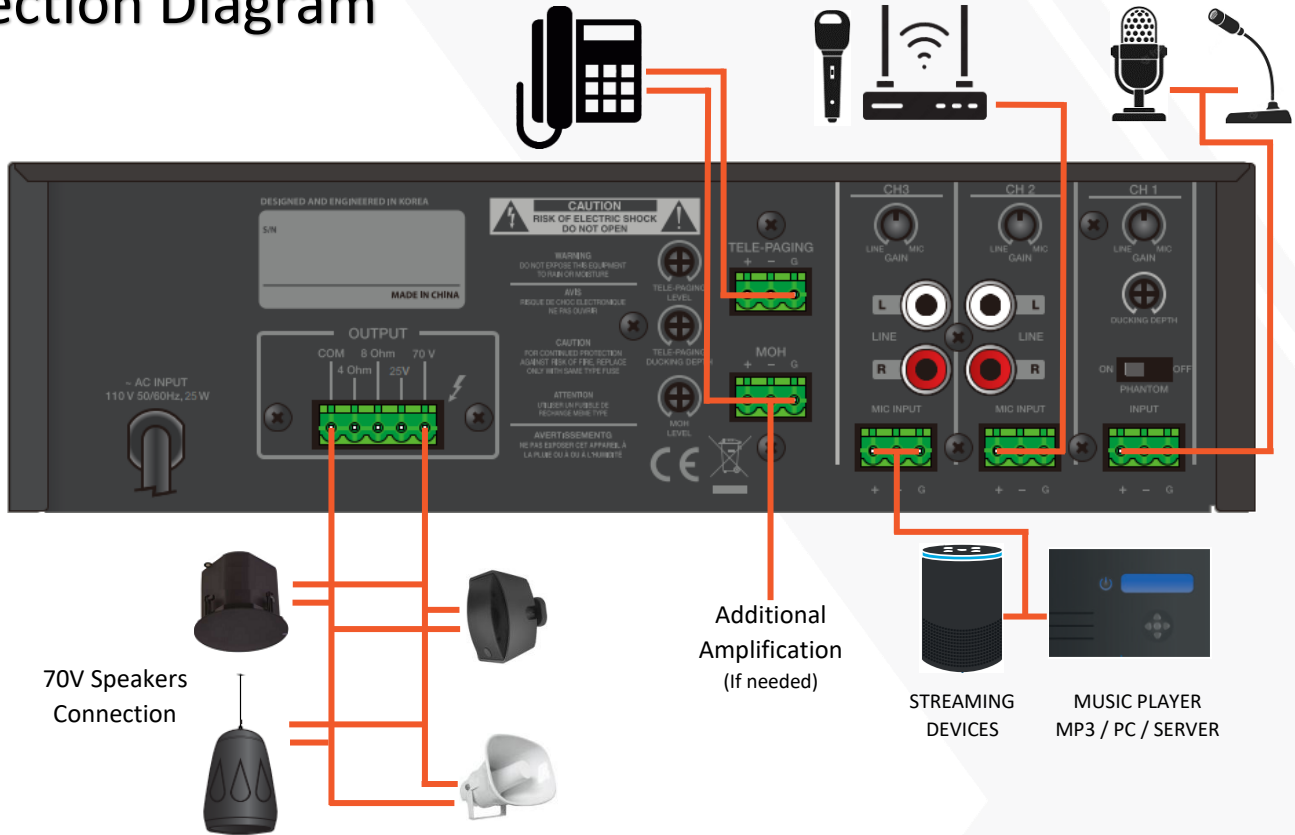

# Specifications

	M65
Rated Power Output	65W
Speaker Output	4Ω/8Ω/25V/70V
Connectors	CH1 : Mic/Line on balanced 3-Conductor Phoenix Connector with Phantom Power CH2-3 : Mic input on 3-Conductor Phoenix Connector, Line input on stereo RCA CH3 : 3.5mm stereo Aux input on front panel
Input Sensitivity /Impedance	MIC 1-3 : '-50dB to -6dB Variable / 20 kΩ Balanced Line 2, 3 : '-30dB to +14dB Variable / 47 kΩ Unbalanced Telephone-Paging : -21dB ± 3dB / 600 Ω Balanced
Music On Hold Output Level	∞ to +10 dB Variable / 600Ω Balanced
Frequency Response	80Hz - 18kHz (±3dB)
Tone Control	±10dB for bass and treble
S/N Ratio	< 90 dB
T.H.D (1 kHz)	< 0.5 %
Protection	Output Current Limiting, Thermal Protection & DC Offset Protection
Power Supply	110V AC, 50-60Hz
Chassis Dimensions	10.63" x 3.0" x 9.06" (270 x 76 x 230mm)
Weight (Net)	7.91 lbs. (3.59 kg)
Master Carton Qty	4
UPC Code	801128114095